

**RAJAS DENTAL COLLEGE AND HOSPITAL
TIRUNELVELI - 627 105**

NACC ACCREDITED

RESULTS FRAMEWORK DOCUMENT

INDEX

I. Results Framework Document.....	3
II. Prosthodontics and Crown & Bridge.....	4
III. Conservative Dentistry and Endodontics.....	6
IV. Periodontology.	9
V. Orthodontics & Dentofacial Orthopedics	14
VI. Oral & Maxillofacial Surgery.....	18
VII. Oral & Maxillofacial Pathology and Oral Microbiology	23
VIII. Oral Medicine & Radiology.....	25
IX. Pediatric Dentistry.....	27
X. Public Health Dentistry.....	32



PRINCIPAL
RAJAS DENTAL COLLEGE & HOSPITAL
KAVALKINARU JN - 627 105.
TIRUNELVELI DISTRICT.

RESULTS FRAMEWORK DOCUMENT (RFD)

The RF provides a summary of the most important results that a specific teaching program or curriculum initiative expects to achieve during a defined period of time, typically in an academic year.

The RF serves two main purposes:

- To aid in helping the Faculty and Institution progress from process-orientation to result-orientation
- Provide an objective and fair basis to evaluate programs overall performance at the end of the defined period

This Results Framework Document should have a stated vision, with definite Vision, Mission Objectives and Function that lead to an outcome

Vision: To provide quality dental education, incorporating new knowledge, innovation with state of the art technological developments in each speciality, to provide quality dental health care services locally at global standards

Mission: Regular and consistent updation of Restorative, Surgical, & Preventive treatment care and Education with an emphasis on research related to basic health needs

Delivery of Tertiary dental operatory and surgical care services in tandem with the Social Welfare Schemes of the Government, providing dental health for all with community participation

Objective: To provide quality Dental Education facilities with a vibrant Centre of Research and provision of integrated Quality Health Care Services with equity.

Functions: Planning and Execution of quality education CDE programmes at State, National and International level, to promote planning and execution of research work, direct and supervise designing new facilities and maintenance of existing infrastructure, procurement of equipment and instruments in tandem with constant updation of treatment facilities, increase public awareness of the Institutions treatment facilities and modalities and implementation of policy



PRINCIPAL
RAJAS DENTAL COLLEGE & HOSPITAL
KAVALKINARU JN - 627 105.
TIRUNELVELI DISTRICT.

BRANCH I - PROSTHODONTICS AND CROWN & BRIDGE

Specific Performance Requirements from Prosthodontics

Sl. No.	Relevant Success indicators	What do you need	Why do you need	How much you need	What happens if you do not get it
Equipment					
1	Digital dentistry	Intraoral scanner	Digital innovation	1	Lagging in tech'
2	-do-	Digital smile designing soft ware	-do-	-	-do-
3	Comprehensive care	Soft tissue laser	For crown lengthening and minor procedures	1	Delay in tmt' due to referrals
4	Advanced restorative options	Chair side CAD-CAM	Crown-in-a-day	1	Patient waiting can be cut down for single crown etc.
Infrastructure/Academics					
1	Upgradation of Pre-Clinical Lab	Total revamp of pre clinical lab with high end equipment, robotics, infotainment and the like.	PCL is not modified for the past 2 decades!	-	Lagging in infrastructure
2	To incorporate recent advancements	Upgradation of the Cr-Co/Ceramic lab	To enable All-ceram and DMES crowns	As per need	-do-



**PRINCIPAL
RAJAS DENTAL COLLEGE & HOSPITAL
KAVALKINARU JN - 627 105,
TIRUNELVELI DISTRICT.**

[Faint watermark text]

Linkage between outcome / impact and financial inputs and number of indicators

Sl.No.	Outcome/ Impact identified in Section	Relative importance (weight) in %	Number of Plan / Non Plan Schemes focused on the indicator	Total Budget for the scheme	Total number of indicators focused on each outcome	Total weight of all indicators
Equipment						
1	Intraoral scanner	75%	nil	Rs.15,00,000	-	-
2	Digital smile designing soft ware	80%	-	Rs.50,000	-	-
3	Soft tissue laser	70%	-	Rs.3,50,000	-	-
4	Chair side CAD-CAM	65%	-	Rs.20,00,000	-	-
Infrastructure/Academics						
1	Upgradation of Pre-Clinical Lab	100%	1	Rs.25,00,000	-	-
2	Upgradation of the Cr-Co/Ceramic lab	70%	-	1-2C	-	-

Description / Definition of outcome / Impact and how each of them will be measured?

Who will measure them and when?

Sl. No.	Outcome	Impact	Weight		Reasons (if it is not measureable)	Total Allocated Budget (Rs)
			Who	When		
Equipment						
1	Intraoral scanner Digital innovation adding to cutting edge tech'	100%	-	-	Better Patient compliance and acceptance Research possibilities	Rs.15,00,000
2	Digital smile designing soft ware	80%			More acumen in smile designing	Rs.50,000
3	Soft tissue laser	80%			More patient compliance	Rs.3,50,000
4	Chair side CAD-CAM	100%			Crown in a day can up our ante	Rs.20,00,000
Infrastructure/Academics						
1	Upgradation of Pre-Clinical Lab	100%	-	-	Need of the hour	Rs. 25,00,000
2	Upgradation of the Cr-Co/Ceramic lab	80%	-	-	Futuristic gesture	1-2 C



PRINCIPAL
RAJAS DENTAL COLLEGE & HOSPITAL
KAVALKINARU JN - 627 105.
TIRUNELVELI DISTRICT.

BRANCH II - CONSERVATIVE DENTISTRY & ENDODONTICS

Specific Performance Requirements from other Departments

Departments	Relevant Success indicators	What do you need	Why do you need	How much you need	What happens if you do not get it
Oral medicine	Increase in special cases performed by students in accordance with international standards In-Vitro studies	CBCT which allows construction of templates for endodontic procedures	Orifice oriented root canal treatment is gaining popularity throughout the world	12 cases /Month	Students will not be benefitted Scientific publications in international journals will not happen
Prosthodontics	More number of, full mouth rehabilitations, FPD and single full coverage restorations placed	Relevant case referrals from department of prosthodontics Face bow transfer and inter-department cooperation	For the betterment of patient care and improved skills of PG students	6 cases per month	Certain patients who require multidisciplinary approaches may not get benefitted
Pedodontics	More number of pedodontic patients getting vital pulp treatments	More case referral from pedodontics department	Most pulpally damaged permanent tooth can be revitalized	3/month	Pedodontic patients may not get benefitted PG student exposure of pedodontic cases will become obscure
Periodontics	More number of endo-perio combined case managements	Referral of patients for hemisection, bicuspidization, root amputation, RCT, splinting and relevant cases	Early referral will have better prognosis and patient satisfaction	6 cases per month	Periodontally compromised teeth with endodontic involvement may go for extraction otherwise
Oral surgery	Trauma patients referred to conservative department	referral to conservative department	Rehabilitation and reimplantation of traumatized teeth	3 cases per month	Students and patients will not be benefitted

PRINCIPAL
RAJAS DENTAL COLLEGE &
KAVALKINARU JN -
TIRUNELVELI DIS.

Linkage between outcome / impact and financial inputs and number of indicators

Sl.No.	Outcome/ Impact identified in Section	Relative importance (weight) in %	Number of Plan / Non Plan Schemes focused on the indicator	Total Budget for all the schemes in Column 4	Total number of indicators focused on each outcome	Total weight of all indicators in Column 6 /100
1	2	3	4	5	6	7
1.	Restorations	70%	4	usage of existing resources	2	100
2.	Endodontic treatment	90%	5	usage of existing resources	2	100
3.	Full coverage restorations	70%	4	One lakh rupees	2	80
4.	Endodontic surgery	40%	2	80,000 rupees	2	80

Description / Definition of outcome / Impact and how each of them will be measured?

Who will measure them and when?

Sl. No.	Outcome/ Impact/10	Weight		Reasons (if it is not measureable)	Total Allocated Budget	
		Who	When			
1	2	3	4	5	6	7
1.	Endodontic microscopic station	8	Inter department auditor	yearly		Yet to be allotted
2.	LASER clinic	7	Inter department auditor	yearly		Yet to be allotted
3.	Esthetic clinic	8	Inter department auditor	yearly		Yet to be allotted
4.	Patient education setup	9	Inter department auditor	yearly		Yet to be allotted
5.	Research department	6	Faculty from central research lab	yearly		Rs.50,000



PRINCIPAL

**RAJAS DENTAL COLLEGE & HOSPITAL
KAVALKINARU JN - 627 105.
TIRUNELVELI DISTRICT.**

Planned Academic Activities

1. Conduct a Clinical skill development program regarding the importance of microscopes in Restorative dentistry and Endodontics.
2. Conduct hands on program on post and core fabrication.
3. CDE Programs on management of avulsed teeth and management of teeth with open apex.
4. Enhance learning programs on newer retrograde filling materials.
5. Tips and tricks in Rubberdam application with recent advances.
6. Conduct a clinical skill development program on Rotary endodontics.
7. Conduct power series programs in collaboration with IACDE.



PRINCIPAL
RAJAS DENTAL COLLEGE & HOSPITAL
KAVALKINARU JN - 627 105.
TIRUNELVELI DISTRICT.

BRANCH III - PERIODONTOLOGY

Specific Performance Requirement from other Departments

Department	Relevant Success indicators	What do you need	Why do you need	How much you need	What happens if you do not get it
Oral medicine	Increase in special cases performed by students with more of case specific referrals	Comprehensive diagnosis of periodontal disease especially in systemically compromised cases / identification of risk factors /genetic disorders. CBCT reconstruction of periodontal defects and 3D Cad cam aided surgeries	For better patient management /early diagnosis and treatment outcome Better surgery outcome	12 cases /Month	Early diagnosis and treatments will not happen Patients will not be benefitted Students will not be exposed to complex cases Scientific publications in international journals will not happen Lesser exposure to advanced techniques.
Prosthodontics	Increase in number of full mouth rehabilitations with adjunctive soft and hard tissue management /augmentation procedures - ridge preservation procedures	Relevant case referrals from department of prosthodontics & inter-department collaboration	For the betterment of patient care and to improve skills of PG students More cases converted as special cases	6 cases per month	Certain patients who require multidisciplinary approaches may not get benefitted Students will not be exposed to finer details of restorative dentistry
Orthodontics	Performance of interdisciplinary cases like gingivoplasty, canine exposure, PAOO etc.	Relevant case referrals from department of orthodontics & inter-department collaboration	For the betterment of patient care and improved skills of PG students More cases converted as special cases	6 cases per month	Certain patients who require multidisciplinary approaches may not get benefitted Students will not be exposed to finer details of interdisciplinary dentistry

Implantology	Performance of soft tissue & hard tissue augmentation around implants in Stage I or Stage II Implant Peri-Implantitis management	Identification of such cases & Relevant case referrals from department of Implantology & inter-department collaboration	Students will get exposed to advanced implant surgical procedures and management of complications For the betterment of patient care	6 cases per month	Certain patients who require multidisciplinary approaches may not get benefitted Can lead to Failures in cases in the esthetic and functional aspects
Pedodontics	Referral of more number of pedodontic patients requiring full mouth rehabilitation Diagnosis, prevention and management of periodontal disease in children with special needs	Diagnosis and referral of cases with genetic disorders and drug history affecting the periodontium	Early identification of periodontal disorders and timely management. Crown lengthening procedures, tongue tie procedure can be performed	3/month	Pedodontic patients may not get benefitted PG student exposure of pedodontic cases will become obscure
Endodontics	Referral of more number of cases with endo-perio lesions Full mouth rehabilitation of cases requiring Endo-perio management	Referral of patients for hemisection, bicuspidization, root amputation, apicoectomy, splinting and relevant cases	Early referral will have better prognosis and patient satisfaction	6 cases per month	Periodontally compromised teeth with endodontic involvement which can be saved may go for extraction otherwise Lack of periodontal opinion and management may lead to failures.



PRINCIPAL

**RAJAS DENTAL COLLEGE & HOSPITAL
KAVALKINARU JN - 627 105.
TIRUNELVELI DISTRICT.**

Public Health dentistry	Increase in patient awareness and reaching out to local population about oral hygiene knowledge and various periodontal procedures and smoking cessation	Interdepartment school/public dental camps/ exclusive perio awareness programme and referral of such cases	To give better knowledge about oral hygiene and periodontal procedures.	3/Month	Patient awareness will be bleak Less number of camp cases walking into periodontics department.
Oral surgery	Trauma patients, CA patients referred to periodontics department for periodontal assessment, management and maintenance	Referral of patients who need oral prophylaxis prior to major surgeries	Prevention of postsurgical infections	6 cases per month	Students will not be benefitted. Patient care will be compromised
Restorative clinic	More case referrals and performance of interdepartment cases	Interdisciplinary management of endo-perio-prostho cases for full mouth rehabilitation and formulation of separate clinic for management of such cases	Students will get exposed to advanced procedures and management of complications For the betterment of patient care	4 cases per month	Patients who require advanced multidisciplinary approaches may not get benefitted



PRINCIPAL
RAJAS DENTAL COLLEGE & HOSPITAL
KAVALKINARU JN - 627 105.
TIRUNELVELI DISTRICT.

சென்னை
 மருத்துவ கல்வி ஆணையர்
 கல்வி அமைச்சு
 திருச்சி

Linkage between outcome / impact and financial inputs and number of indicators

Sl.No.	Outcome/ Impact identified in Section	Relative importance (weight) in %	Number of Plan / Non Plan Schemes focused on the indicator	Total Budget for all the schemes in Column 4	Total number of indicators focused on each outcome	Total weight of all indicators in Column 6 /100
1	2	3	4	5	6	7
1.	Scaling and root planning	90%	4	Usage of existing resources	2	100
2.	Minor surgical procedures	70%	5		2	100
3.	Pocket reduction surgeries	80%	5		3	100
4.	Perio plastic surgeries	70%	4		3	80
5.	Interdisciplinary procedures	80%	3		2	80

Description / Definition of outcome / Impact and how each of them will be measured?

Who will measure them and when?

Infrastructure:

Sl.No.	Outcome/	Impact/10	Weight		Reasons (if it is not measureable)	Total Allocated Budget
			Who	When		
1	2	3	4	5	6	7
1	Advanced Implant clinic	5	Inter department auditor	yearly		Rs 85000
2	LASER Esthetic clinic	7		yearly		Rs 40,000
3	Patient education Unit	7		yearly		Rs 10,000
4	Comprehensive Restorative Clinic	6		yearly		Existing resources

PRINCIPAL

**RAJAS DENTAL COLLEGE & HOSPITAL
KAVALKINARU JN - 627 105.
TIRUNELVELI DISTRICT.**

Academic

Sl. No.	Outcome/	Impact	Weight		Reasons (if it is not measureable)	Total Allocated Budget
			Who	When		
1	2	3	4	5	6	7
1	Skill development Programs	7	Department auditor	After each Program		Rs.15000
2	Restorative Clinic Collaboration	7	Interdepartment auditor	After each Program		Existing resources
3	Perio Awareness Camps	6	Interdepartment auditor	Monthly		Existing resources
4	CDE Programme	7	Department auditor	After each Program		Rs.10000

Equipment

Sl. No.	Outcome/	Impact	Weight		Reasons (if it is not measureable)	Total Allocated Budget
			Who	When		
1	2	3	4	5	6	7
1	Patient counselling office	7	Department auditor	Yearly		Rs.25000

PRINCIPAL
RAJAS DENTAL COLLEGE & HOSPITAL
KAVALKINARU JN - 627 105.
TIRUNELVELI DISTRICT.

BRANCH IV - ORTHODONTICS & DENTOFACIAL ORTHOPEDICS

Specific Performance Requirements from other Departments

Departments	Relevant Success indicators	What do you need	Why do you need	How much you need	What happens if you do not get it
Oral medicine	Increase in diagnosis and counseling of patients with malocclusion CBCT	Referral to orthodontics department Data of All cases to evaluate	To increase number of cases for students' learning To provide treatment for the needy To evaluate impacted canine, orthognathic surgical cases, pathologies, Research purpose	Daily - 20 Monthly - 5	Students and patients will not be benefitted Lack of thorough diagnosis and CBCT research studies.
Oral surgery	Increase in orthognathic surgical cases, impacted canine cases, TMJ disorder patients	Referral to orthodontics department; Interdepartmental meetings	-To increase the number of cases for students' learning -To provide Treatment for the needy For a multi-disciplinary treatment planning	Weekly -1	Students and patients will not be benefitted
Prosthodontics	Increase in patients for adjunctive orthodontic procedures	Referral to orthodontics department; Interdepartmental meetings	For better patient care For a multi-disciplinary treatment planning	Weekly -1	Students and patients will not be benefitted
Endodontics	Increase in patients for adjunctive orthodontic procedures	Referral to orthodontics department; Interdepartmental meetings	For better patient care For a multi-disciplinary treatment planning	Weekly -1	Students and patients will not be benefitted



PRINCIPAL

**RAJAS DENTAL COLLEGE & HOSPITAL
KAVALKINARU JN - 627 105.
TIRUNELVELI DISTRICT.**

Pedodontics	Counseling patients for interceptive and preventive orthodontic procedures	Referral to orthodontics department	Early diagnosis and management of malocclusions like growth modification procedures	Weekly- 5	Students and patients will not be benefitted
Periodontics	Increase in patients for adjunctive orthodontic procedures	Referral to orthodontics department; Interdepartmental meetings	For better patient care For a multi-disciplinary treatment planning	Weekly - 1	Students and patients will not be benefitted
Public health	Orthodontic cases	Camps	Early detection of malocclusions and counseling of patients for orthodontic treatment	Quarterly - 1 Camp	Students and patients will not be benefitted

Linkage between outcome / impact and financial inputs and number of indicators

Sl. no	Outcome/ Impact Identified in Section	Relative Importance (weight) in %	Number of Plan / non Plan Schemes Focused on the indicator	Total budget for all the Schemes in column 4	Total number of indicators focused on Each Outcome	Total weight of all Indicators in column 6 /100
1	2	3	4	5	6	7
1	Fixed mechanotherapy cases	90%	2	Rs. 5,60,000/-	Fixed orthodontic cases	90
2	Functional appliance and growth modification procedures	20%	3	Rs. 20,000/-	Functional and orthopaedic cases	20
3	Research data	100%	2	Usage of Existing Resources	Research paper	100



PRINCIPAL

RAJAS DENTAL COLLEGE & HOSPITAL
KAVALKINARU JN - 627 105.
TIRUNELVELI DISTRICT.

4	Adjunctive orthodontic procedures	20%	4	Rs. 1,12,000/-	Interdisciplinary management	20
5	Surgical cases	20%	1	Rs. 1,12,000/-	Interdisciplinary management	20
6	Removable appliances	40%	2	Rs. 40,000/-	Removable orthodontic cases	40

Infrastructure:

Sl. no.	Infrastructure requirement	Total budget	Relative Importance (weight) in %
1	Record room for storing diagnostic records in the orthodontics department: <ul style="list-style-type: none"> - Cupboards for keeping orthodontic diagnostic records of patients - Boxes for storing study models 	Rs. 50,000/- Rs. 10,000/-	90%
2	Orthodontics pre clinical lab(II year BDS and III year BDS) renovation	Rs. 2,00,000/-	90%

Equipments:

Sl. no.	Equipments	Total budget	Relative Importance (weight) in %
1	Digitalization of appointments and patient records	Rs. 1,00,000/-	70%
2	Intraoral scanner	Rs. 10,00,000/-	70%

PRINCIPAL
RAJAS DENTAL COLLEGE & HOSPITAL
KAVALKINARU JN - 627 105.
TIRUNELVELI DISTRICT.

Description / Definition of outcome / Impact and how each of them will be measured?

Who will measure them and when?

Sl. No.	Outcome/	Impact/ 10	Weight		Reasons (if it is not Measureable)	Total Allocated Budget
			Who	When		
1	2	3	4	5	6	7
1.	Cases	9	Audit	Yearly	-	Rs. 6,20,000/-
2.	Interdisciplinary cases	7	Audit	Yearly	-	Rs. 2,24,000/-
3.	Research Paper	10	Publication	Yearly	-	-
4.	Infrastructure	9	Audit	Yearly	-	Rs. 2,60,000/-
5.	Equipments	7	Audit	Yearly	-	Rs. 11,00,000/-



**PRINCIPAL
RAJAS DENTAL COLLEGE & HOSPITAL
KAVALKINARU JN - 627 105.
TIRUNELVELI DISTRICT.**

BRANCH V - ORAL & MAXILOFACIAL SURGERY

Specific Performance Requirements from other Departments

Departments	Relevant Success indicators	What do you need	Why do you need	How much you need	What happens if you do not get it
Oral medicine and radiology	Increase in diagnosis and counseling of patients with dental caries who need extraction, impacted teeth, cyst, tumors etc IOPA, OPG, CBCT	Referral to oral and maxillofacial surgery department To send the patient to oral and maxillofacial surgery department with appropriate radiological images	To increase the number and variety of cases for students' learning To provide treatment for the needy To plan the treatment, research purpose	Daily - 20 Daily - 5	Students and patients will not be benefitted Students and patients will not be benefitted
Oral pathology	Biopsy and cytology reports for the specimen sent to the department	Timely issuance of biopsy and cytology reports	To plan the treatment in case of incisional biopsy, To know the prognosis in case of excisional biopsy, research purpose	Daily - 1	Students and patients will not be benefitted Patients cannot be planned /referred for appropriate further treatment
Orthodontics	Increase in diagnosis and counselling of patients with skeletal malocclusion and those who need adjunctive surgical treatment	Referral to oral and maxillofacial surgery department before starting orthodontic treatment	To provide best outcome for the patient who need combined ortho-surgical treatment Timely done adjunctive surgery will aid the quick finishing of orthodontic treatment	Weekly - 1	Students and patients will not be benefitted Patients treatment time is prolonged



PRINCIPAL
RAJAS DENTAL COLLEGE & HOSPITAL
KAVALKINARU JN - 627 105.
TIRUNELVELI DISTRICT.

Prosthodontics	Increase in diagnosis and counseling of patients who need preprosthetic surgical treatment	Referral to oral and maxillofacial surgery department before starting definite prosthodontic treatment	To provide best outcome for the patient who need preprosthetic surgery	<u>Weekly - 1</u>	Students and patients will not be benefitted Patients' treatment is compromised
Endodontics	Increase in diagnosis and counseling of patients who need endodontic surgical treatment	Referral to oral and maxillofacial surgery department promptly after completing definite endodontic treatment	To provide best outcome for patient who need endodontic surgery	<u>Weekly - 1</u>	Students and patients will not be benefitted Patients' treatment is compromised
Pedodontics	Increase in diagnosis and counselling of children who need surgical treatment	Referral to oral and maxillofacial surgery department	To provide best outcome for patient	<u>Weekly - 1</u>	Students and patients will not be benefitted
Public health	Increase in diagnosis and counselling of persons who need oral and maxillofacial surgical treatment	To conduct regular camps to screen for persons who need oral and maxillofacial surgery	To create an oral healthy, disease-free society	<u>Monthly - 1</u>	Community will miss the primary treatment and suffer from the consequences of disease which affects their quality of life



PRINCIPAL
RAJAS DENTAL COLLEGE & HOSPITAL
KAVALKINARU JN - 627 105.
TIRUNELVELI DISTRICT.

Linkage between outcome / impact and financial inputs and number of indicators

Sl.No.	Outcome/ Impact identified in Section	Relative importance (weight) in %	Number of Plan / Non Plan Schemes focused on the indicator	Total Budget for all the schemes in Column 4	Total number of indicators focused on each outcome	Total weight of all indicators in Column 6 (out of 100)
1	2	3	4	5	6	7
1	Mastering extraction of teeth	100%	3	Use existing resources	3	100
2	Suturing oral and facial tissue	100%	3	Use existing resources	3	100
3	Surgical extraction of impacted teeth	100%	3	Use existing resources	3	100
4	Performance of minor oral surgical procedures	90%	3	Use existing resources	3	90
5	Diagnosis and treatment planning for major maxillofacial surgical procedures	90%	2	Rs. 100000	2	90



PRINCIPAL
RAJAS DENTAL COLLEGE & HOSPITAL
KAVALKINARU JN - 627 105.
TIRUNELVELI DISTRICT.

சென்னை
 காவல்கினாரு ஜி.என்.டி.எல்.டி.
 காவல்கினாரு ஜி.என்.டி.எல்.டி.
 காவல்கினாரு ஜி.என்.டி.எல்.டி.

Description / Definition of outcome / Impact and how each of them will be measured?

Who will measure them and when?

Sl. No.	Outcome/	Impact	Weight		Reasons (if it is not measureable)	Total Allocated Budget
			Who	When		
1	2	3	4	5	6	7
1	Suturing in dummy model	90%	Student coordinator of department	Monthly	-	Use existing resources
2	Dental wiring in dummy model	90%	Student coordinator of department	Monthly	-	Use existing resources
3	Bone plating in dummy model	90%	Student coordinator of department	Yearly	-	Use existing resources
5	Tooth cutting in dummy model	90%	Student coordinator of department	Yearly	-	Use existing resources
6	Case discussion before operating on the patient	80%	Student coordinator of department	Daily	-	Use existing resources
7	Case presentation before operating on the major cases	80%	Student coordinator of department	Weekly	-	Use existing resources



PRINCIPAL
RAJAS DENTAL COLLEGE & HOSPITAL
KAVALKINARU JN - 627 105.
TIRUNELVELI DISTRICT.

Infrastructure requirement

Sl. no.	Infrastructure requirement	Total budget	Relative Importance (weight) in %
1	Record room for storing diagnostic records - Cupboards for keeping Surgical records of patients	Rs. 1,00,000/-	90%
2	Combining UG and PG clinic next to each other	Rs. 3,00,000/-	90%

Equipment requirement

Sl. no.	Equipments	Total budget	Relative Importance (weight) in %
1	Diathermy (Bipolar)	Rs. 1,00,000/-	70%
2	Piezo surgical unit	Rs. 3,00,000/-	70%
3	Biolase Laser	Rs. 2,40,000/-	90%
4	B type Autoclave (2nos)	Rs. 2,00,000/- each	100%

Planned Academic Activities

1. Conduct a Clinical skill development program regarding the importance of major and minor oral surgery.
2. Conduct hands on program on suturing and minor oral surgical procedures.
3. CDE Programs on lasers.
4. Conduct programs in collaboration with AOMSI.



PRINCIPAL
RAJAS DENTAL COLLEGE & HOSPITAL
KAVALKINARU JN - 627 105.
TIRUNELVELI DISTRICT.

**BRANCH VI - ORAL & MAXILOFACIAL PATHOLOGY AND ORAL
MICROBIOLOGY**

Specific Performance Requirements from other Departments

Departments	Relevant Success indicators	What do you need	Why do you need	How much you need	What happens if you do not get it
Oral medicine	increase in cytology and biopsy cases CBCT	referral to oral pathology Data of older case to evaluate	motivate for diagnostic importance age and sex determination	<u>WEEKLY</u> cytology -10 biopsy -6 once in 6 months	Students will not be benefitted Forensic odontology library – lack of data
Oral surgery	Increase in biopsy cases	Referral to oral pathology	motivate for diagnostic importance	<u>WEEKLY</u> biopsy -6	Students will not be benefitted
Tobacco cessation clinic	Awareness of ill-effect of tobacco	Referral to oral pathology	Stop addiction to tobacco	<u>DAILY</u> Cases -2	Lack Of Biopsy cases
Public health	Oncology cases	Camp	early detection of malignancy	quarterly -1 camp	Population based case awareness studies

Linkage between outcome / impact and financial inputs and number of indicators

Sl.No.	Outcome/ Impact identified in Section	Relative importance (weight) in %	Number of Plan / Non Plan Schemes focused on the indicator	Total Budget for all the schemes in Column 4	Total number of indicators focused on each outcome	Total weight of all indicators in Column 6 /100
1	2	3	4	5	6	7
1.	Biopsy tissue archival	90%	3	Usage of existing resources	Cases study material	90
2.	Forensic library	60%	1	usage of existing resources	Establishment of forensic department	60
3.	Epidemiological data	100%	4	50,000/-	Research paper	100



**PRINCIPAL
RAJAS DENTAL COLLEGE & HOSPITAL
KAVALKINARU JN - 627 105.
TIRUNELVELI DISTRICT.**

Description / Definition of outcome / Impact and how each of them will be measured?

Who will measure them and when?

Sl. No.	Outcome/	Impact/10	Weight		Reasons (If it is not measurable)	Total Allocated Budget
			Who	When		
1	2	3	4	5	6	7
1.	Cases Study material	9	Examiner	yearly		-
2.	Establishment of forensic department	7	Audit	yearly		-
3.	Research paper	10	Publication	yearly		50000/-

Infrastructure

- Proposed new radiology building to be constructed. Plan has been approved already by Chairman.

Equipment

- It's more than a decade our OPG machine has been running successfully, the sensor of the machine is slowly getting worn out. Depending on the wear and tear of the sensor, we may need to replace it as in when necessary.

Academics

- Increase in post graduate seat (1 seat)

PRINCIPAL
RAJAS DENTAL COLLEGE & HOSPITAL
KAVALKINARU JN - 627 105.
TIRUNELVELI DISTRICT.

BRANCH VII - ORAL MEDICINE & RADIOLOGY

Specific Performance Requirements from other Departments

Departments	Relevant Success indicators	What do you need	Why do you need	How much you need	What happens if you do not get it
Oral pathology	Cytology reports Biopsy reports from the specimen provided	Histo-pathological assessments Investigatory reports	Better management of the patient	<u>WEEKLY</u> Biopsy-2 Cytology-5	Effective management of patients will be hampered
Oral surgery	Complex biopsy cases Management of Cystic and Malignant lesions aiding in final diagnosis	Report of the biopsies helps in final diagnosis	motivate for diagnostic importance	<u>WEEKLY</u> biopsy – 5 to 10	Patients and students will not be benefitted
Tobacco cessation clinic	Making the patient aware of the harmful effects of tobacco	Community outreach and increase in patients	Stop addiction to tobacco	<u>DAILY</u> Cases -20	Decrease in social awareness and reduction of patients
Public health Implantology	Oncology camps conducted along with Public health Referral of patients for CBCT	Camp CBCT scans	early detection of malignancy Treatment planning and assessment	Quarterly -1 camp <u>WEEKLY</u> CBCT – 5	Post graduation case dearth Lacunae in the treatment



PRINCIPAL
RAJAS DENTAL COLLEGE & HOSPITAL
KAVALKINARU JN - 627 105.
TIRUNELVELI DISTRICT.

Linkage between outcome / impact and financial inputs and number of indicators

SLNo.	Outcome/ Impact identified in Section	Relative importance (weight) in %	Number of Plan / Non Plan Schemes focused on the indicator	Total Budget for all the schemes in Column 4	Total number of indicators focused on each outcome	Total weight of all indicators in Column 6 /100
1	2	3	4	5	6	7
1	CBCT imaging	90%	1- Referral within campus 2- Referral from outside	usage of existing resources	Better imaging for proper diagnosis	90
2	OPG and other extra oral imaging	90%	1	usage of existing resources	Adjuvant tools for better diagnosis and management	90
3	IOPA	100%	1	usage of existing resources	Basic and easy tool for better diagnosis	90
4	Outpatient cases	100%	4	-	Clinical material for college	100

Description / Definition of outcome / Impact and how each of them will be measured?

Who will measure them and when?

Sl. No.	Outcome/ Impact/10	Weight	Weight		Reasons (if it is not measurable)	Total Allocated Budget
			Who	When		
1	2	3	4	5	6	7
1	Cases Study material	9	Examiner	yearly		-
2	Establishment of radiology department	8	Audit	Daily		-
3	Research paper	10	Publication	yearly		Rs.50000/-

PRINCIPAL
RAJAS DENTAL COLLEGE & HOSPITAL
KAVALKINARU JN - 627 105.
TIRUNELVELI DISTRICT.

BRANCH VIII –PEDIATRIC DENTISTRY

Specific Performance Requirements from Department of Pedodontics

Infrastructure

What do you need	Why do you need	What happens if you do not get it
Expansion of Department for PG	Lack of PG	Couldn't proceed to Develop Department as a postgraduate

Academic

What do you need	Why do you need	How much you need	What happens if you do not get it
Webinar on Importance of Breast Feeding by Dr.Saravanakumar	Improve students knowledge on Importance of Feeding	1	Students couldn't improve their knowledge on Scope of Pediatric Dentistry
CDE programme on Conscious Sedation and WAND by Dr.Raju Sunny	Improve students knowledge on Conscious Sedation and WAND	1	Students couldn't improve their knowledge on Scope of Pediatric Dentistry

Equipment

What do you	Why do you need	How much you need	What happens if you do not get it
Conscious Sedation Unit	Aids in better patient behaviour management	1	Behaviour management is hindered
Apex Locator	Helps to improve quality of treatment	1	Won't be able to provide proper treatment
Endomotor	Helps to improve quality of treatment	1	Won't be able to provide proper treatment
SS Crown for Permanent Kit	No other semi permanent options available for young permanent teeth	1	Couldn't complete treatment for young permanent teeth

PRINCIPAL
RAJAS DENTAL COLLEGE & HOSPITAL
KAVALKINARU JN - 627 105.
TIRUNELVELI DISTRICT.

Specific Performance Requirements from other Departments

Departments	Relevant Success indicators	What do you need	Why do you need	How Much you need	What happens if you do not get it
OralMedicine	Increase in special cases	Assessment of syndromes	To promote Speciality care/to increase Academic knowledge of students and staff	2/Month	Students are deprived of Knowledge about syndro
Conservative Dentistry	More number of Patients getting Vital/Non vital Pulp therapy for young Permanent teeth	Referral of relevant cases from Conservative Dentistry	Management of Young Permanent Teeth	5/Month	Certain Patients w needs multidisciplinary approach may not benefitted
Oral Surgery	Trauma patients referred to Pedodontics	Referral of relevant cases from Oral Surgery	Rehabilitation and Reimplantation in trauma patients	1/Month	Certain Patients w needs multidisciplinary approach may not benefitted
Public Health Dentistry	Increase in patient awareness and reaching out local population about oral hygiene knowledge	Interdepartment School/ Public Dental Camps	To give better Knowledge about oral hygiene and other dental anamolies	3/Month	Patient awareness could not be creat
Orthodontics	Increase in Preventive Orthodontic procedures	Referral of relevant cases From Orthodontics	Management of Developing Dentition	2/Month	Certain Patients w needs Multidisciplinary approach may not benefitted
Prosthodontics	More number of Full mouth rehabilitation of pedodontic special cases	Referral of relevant cases from Prosthodontics	For the betterment of Patient care	1/Month	Certain Patients w needs multidisciplinary approach may not benefitted



PRINCIPAL

**RAJAS DENTAL COLLEGE & HOSPITAL
KAVALKINARU JN - 627 105,
TIRUNELVELI DISTRICT.**

Linkage between outcome / impact and financial inputs and number of indicators

SLN o.	Outcome/ Impact identified in Section	Relative importance (weight) in %	Number of Plan / Non Plan Schemes focused on the indicator	Total Budget for all the schemes in Column 4	Total number of indicators focused on each outcome	Total weight of all indicators in Column 6 /100
1	2	3	4	5	6	7
1.	Restorations	90	4	Usage of existing resources	2	100
2.	Young Permanent tooth management	70	4	Usage of existing resources	2	100
3.	Special Cases Full mouth Rehabilitation	50	2	Usage of existing resources + Lab charges	2	80
4.	Preventive Orthodontic procedures	40	1	Usage of existing resources + Lab charges	1	80

Infrastructure

Sl.No.	Outcome/ Impact identified in Section	Relative Importance (weight) in %	Number of Plan / Non Plan Schemes focused on the indicator	Total Budget for all the schemes in Column 4	Total number of indicators focused on each outcome	Total weight of all indicators in Column 6
1	2	3	4	5	6	7
1	PG Intake	10	4	Yet to be Finalised	2	100



PRINCIPAL
RAJAS DENTAL COLLEGE & HOSPITAL
KAVALKINARU JN - 627 105.
TIRUNELVELI DISTRICT.

Equipment

Sl.No.	Outcome/ Impact identified in Section	Relative Importance (weight) in %	Number of Plan / Non Plan Schemes focused on the indicator	Total Budget for all the schemes in Column 4	Total number of indicators focused on each outcome	Total weight of all indicators in Column 6
1	2	3	4	5	6	7
1	Conscious Sedation Unit	90	4	Rs.2.30 Lakh (Approx)	2	100
2	Apex Locator	80	2	Rs.10,000 – Rs.100,000 (Approx)	2	80
3	Endomotor	80	3	Rs.61,000 – Rs.125,000 (Approx)	2	80
4	SS Crown for Permanent Kit	100	1	Rs.25,000 (Approx)	1	100

Academic

Sl.No	Outcome/ Impact identified in Section	Relative importance (weight) in %	Number of Plan / Non Plan Schemes focused on the indicator	Total Budget for all the schemes in Column 4	Total number of indicators focused on each outcome	Total weight of all indicators in Column 6
1	2	3	4	5	6	7
1	Webinar on Importance of Breast Feeding by Dr.Saravanakumar	100	1	Free of cost	1	100
2	CDE programme on Conscious Sedation and WAND by Dr.Raju Sunny	100	1	Registration fee for Participants (Approx Rs.500/Person) Approximate Expected No Of Participants- 200	1	100

PRINCIPAL
RAJAS DENTAL COLLEGE & HOSPITAL
KAVALKINARU JN - 627 105.
TIRUNELVELI DISTRICT.

Description / Definition of outcome / Impact and how each of them will be measured?

Who will measure them and when?

Infrastructure

Sl. No.	Outcome/	Impact	Weight		Reasons (if it is not measureable)	Total Allocated Budget
			Who	When		
1	2	3	4	5	6	7
1	Special care Clinic	10	Interdepartment auditor	Yearly		Yet to be allotted
2	PG Department	10	Department auditor	Yearly		Yet to be allotted

Academic

Sl. No.	Outcome/	Impact	Weight		Reasons (if it is not measureable)	Total Allocated Budget
			Who	When		
1	2	3	4	5	6	7
1	CDE Programs	10	Department auditor	After each program		Allotted
2	Patient Education setup	10	Interdepartment auditor	Yearly		Yet to be allotted
3	School adaptation programs	10	Interdepartment auditor	Monthly		Yet to be allotted

Equipment

Sl. No.	Outcome/	Impact	Weight		Reasons (if it is not measureable)	Total Allocated Budget
			Who	When		
1	2	3	4	5	6	7
1	Patient Management	10	Department auditor	Yearly		Yet to be allotted
2	Young permanent tooth treatment	10	Department auditor	Yearly		Yet to be allotted

BRANCH IX - PUBLIC HEALTH DENTISTRY

Specific Performance Requirements from other Departments

Departments	Relevant Success indicators	What do you need	Why do you need	How much you need	What happens if you do not get it
Oral Medicine & Radiology	General Public Screening Camps	1 Staff and 1 PG	Identification of oral lesions	As and when required	Students will not be benefitted and Lack of patients in college
Prosthodontics	Geriatric Oral Rehabilitation	1 Staff and 1 PG	Rehabilitation of patients in geriatric homes	As and when required	Poor oral functioning of geriatric patients
Pedodontics	School Oral Health Program	1 Staff & 5 Interns	Screening, education and promotion of oral health among schoolchildren	As and when required	Poor oral health among schoolchildren
Tobacco Cessation Clinic	Tobacco Counselling	1 Staff and 1 PG from Oral Medicine	Tobacco Counselling for quitting tobacco usage	15 patients per day	Number of precancerous & cancerous conditions will increase
Conservative Dentistry	Identification of Relevant Patient Cases in General Public Screening Camps	1 PG	To identify potential patients seeking endodontic treatment and referral to college	As and when required	PG students won't be benefitted if referrals to college are not proper
Periodontics	Identification of Relevant Patient Cases in General Public Screening Camps	1 PG	To identify potential patients seeking periodontal treatment and referral to college	As and when required	PG students won't be benefitted if referrals to college are not proper
Orthodontics	Identification of Potential Malocclusions & Deleterious Oral Habits among School and College Students	1 Staff and 1 PG	To identify potential patients seeking orthodontic treatment and referral to college	As and when required	PG students won't be benefitted if referrals to college are not proper
Oral Pathology	Oncology Screening Camps for Special Groups	1 Staff	To identify potential precancerous & cancerous conditions and any other facial anomalies	As and when required	Number of biopsy cases will get reduced and PG students won't be benefitted if referrals to college are not proper

PRINCIPAL

Oral Surgery	Awareness campaign on Oral and Maxillo-facial defects and surgical procedures	1 Staff	Education and promotion of various maxilla-facial defects and surgical procedures	As and when required	Number of surgical cases will get reduced and PG students won't be benefitted
Implantology	Promotion of implant treatment to general public	1 Staff and 5 Interns	Education and promotion of implant procedures among general public during outreach programs	As and when required	Number of implant cases will get reduced and interns (CRRJ) and PG students won't be benefitted

Linkage between outcome / impact and financial inputs and number of indicators

Sl. No.	Outcome/ Impact identified in Section	Relative importance (weight) in %	Number of Plan / Non Plan Schemes focused on the indicator	Total Budget for all the schemes in Column 4	Total number of indicators focused on each outcome	Total weight of all indicators in Column 6 /100
1	2	3	4	5	6	7
1	Epidemiological Data	100%	10	Essentials provided from college	10	100

Description / Definition of outcome / Impact and how each of them will be measured?

Who will measure them and when?

Sl. No.	Outcome	Impact/10	Weight		Reasons (if it is not measureable)	Total Allocated Budget
			Who	When		
1	2	3	4	5	6	7
1	PG Department	10	Department	Year 2022		As decided by Finance section and college management
2	Research Paper	10	Staff Members and Interns	Quarterly		Use research fund from college management
3	Copyright for Oral Health Education Materials	10	Staff Members	As and when required		5000/- per copyright



PRINCIPAL

MDS Requirements – 1 Unit

STAFF

Professor	1
Reader/Associate Professor	2
Lecturer/Assistant Professor	3

PATIENTS PER DAY

Unit	Starting MDS	2 nd Renewal	3 rd & 4 th Renewal	Recognition
1 st Unit	40	45	50	50

DEPARTMENT INFRASTRUCTURE

Facility	Availability
Faculty Rooms	Need 2 More
Clinics	PG Area Needed
Seminar Room	Present
Department Library	Biostatistics Room can be used
PG Common Room	Needed
Patient Waiting Room	Needed

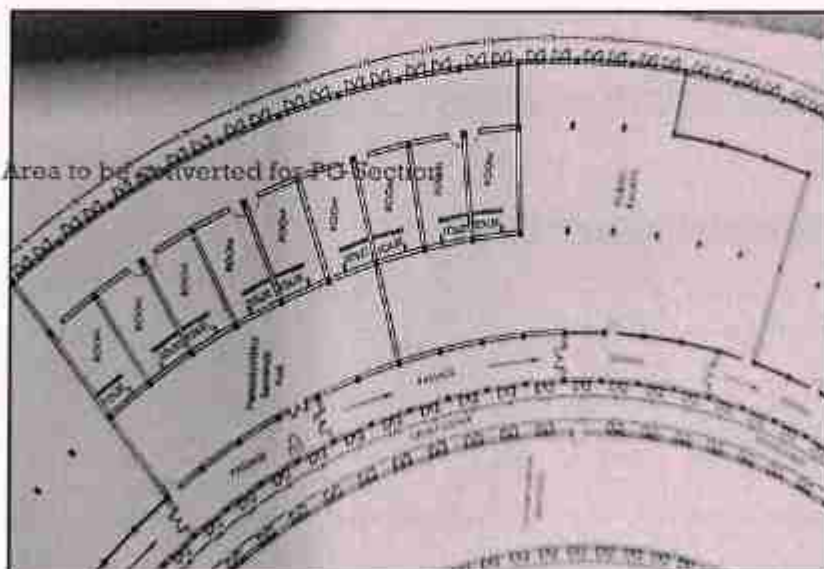

PRINCIPAL
RAJAS DENTAL COLLEGE & HOSPITAL
KAVALKINARU JN - 627 105.
TIRUNELVELI DISTRICT.

Proposed Infrastructure PG Section

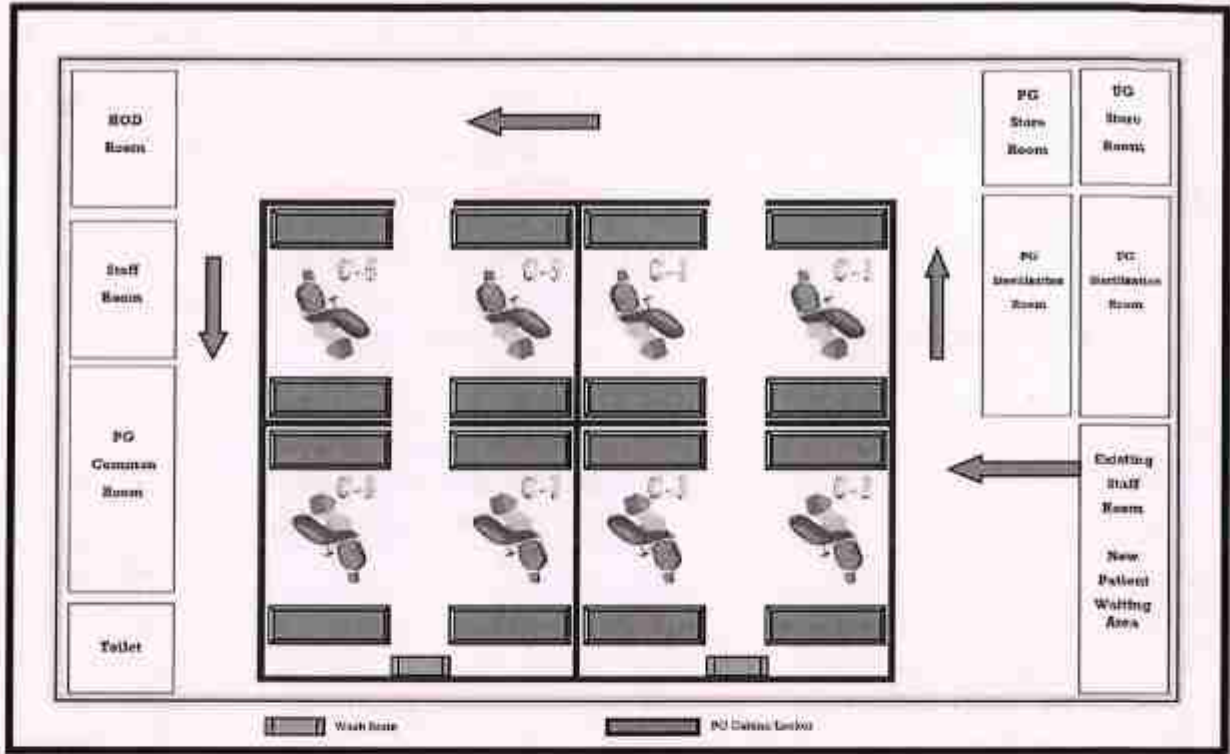

LIBRARY

BOOKS	CENTRAL LIBRARY		DEPARTMENT LIBRARY	
	Required	Available	Required	Available
No. of Titles	20		10	
Total No. of Books				
JOURNALS	International		National	
	Required	Available	Required	Available
	4-6		2-3	
No. of Back volumes in print form (8-10 years) of any 3 journals of concerned specialty	Name of the Journal			Number

PRINCIPAL
RAJAS DENTAL COLLEGE & HOSPITAL
KAVALKINARU JN - 627 105.
TIRUNELVELI DISTRICT.

EQUIPMENT

Sl. No.	NAME	SPECIFICATION	Quantity	Availability
Instruments in the department for comprehensive Oral health care programme				
1	Dental chairs	Electrically operated with shadowless lamp, spittoon, 3 way syringe, instrument tray and motorized suction, micromotor attachment with contra angle handpiece, airoter attachment, ultrasonic scaler (Piezo) with detachable autoclavable hand piece with min 3 tips.	One chair and unit per post-graduate student and one chair with unit for the faculty	Nil
2			1 Unit	
3	Extraction forceps		4 sets	Nil
4	Filling instruments		4 sets	Nil
5	Scaling instruments	Supra gingival scaling	4 sets	Nil
6	Amalgamator		1	Nil
7	Pulp tester		1	Nil
8	Autoclave		1	Need 1 More
9	X-ray viewer		1	Present
10	Instrument cabinet		1	Nil
11	LCD or DLP multimedia projector		1	Nil
12	Computer with internet connection with attached printer and scanner		1	Need Printer and Scanner
For peripheral dental care or field programme				
13	Staff bus		1	Present
14	Mobile dental clinic fitted with at least 2 dental chairs with complete dental unit with fire extinguisher		1	Present (With one chair)
15	Ultrasonic scaler		1	Present
16	Ultrasonic cleaner capacity 3.5 lts		1	Present
17	Compressor	One with chair		Present
18	Generator		1	Present
19	Public address system, audio-visual aids		1	Present
20	Television		1	Present
21	Digital Versatile Disc Player		1	Present
22	Instrument cabinet, emergency medicine kits, Blood pressure apparatus		1	Need Emergency medicine Kits and BP apparatus
23	Portable oxygen cylinder		1	Nil
24	Portable chair		1	Present
25	Refrigerator		1	Nil



PRINCIPAL

RAJAS DENTAL COLLEGE & HOSPITAL

KAVALKINARU JN - 627 105.

TIRUNELVELI DISTRICT